

TOWN AND COUNTRY PLANNING ACT 1971

TOWN AND COUNTRY PLANNING GENERAL DEVELOPMENT ORDER 1977

DIRECTION UNDER ARTICLE 4 RELATING TO LAND IN THE
PARISHES OF BARLAVINGTON AND DUNCTON

WHEREAS the District Council of Chichester of East Pallant House Chichester West Sussex being the Local Planning Authority for the said District are satisfied that it is expedient that development of the description set out in the Schedule hereto should not be carried out on the land situate in the Parishes of Barlavington and Duncton in the County of West Sussex shown edged red on the plan annexed hereto unless permission therefor is granted on application made under the Town and Country Planning General Development Order 1977

AND WHEREAS it is the opinion of the said Council that the said development would be prejudicial to the proper planning of their area and constitute a threat to the amenities of their area and that the provisions of paragraph (3)(b) of Article 4 of the said Order should apply to this Direction

NOW THEREFORE the said Council in pursuance of the powers conferred upon them by the said Article 4 of the Town and Country Planning General Development Order 1977 HEREBY DIRECT that the permission granted by Article 3 of the said Order shall not apply to the development of the said land of the description set out in the Schedule hereto (being development comprised within paragraph 2 of Class IV(of the First Schedule to the said Order)

THIS DIRECTION will remain in force for six months from the date hereof and will then expire unless it has been approved by the Secretary of State for the Environment before that date

SCHEDULE

The use of land (other than a building or the curtilage of a building) for the purposes of clay pigeon shooting and artificial target shooting on not more than twenty eight days in total in any calendar year and the erection or placing of moveable structures on the land for the purpose of that use

DATED this *Sixteen* day of December 1986

THE COMMON SEAL of THE DISTRICT)
COUNCIL OF CHICHESTER was here-)
unto affixed in the presence of:)

and
Authorised Signatory

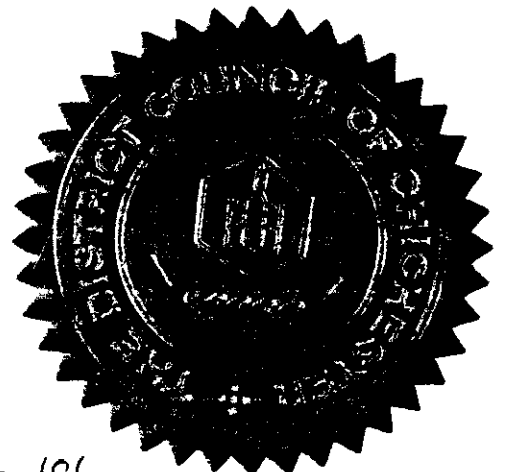

680/86

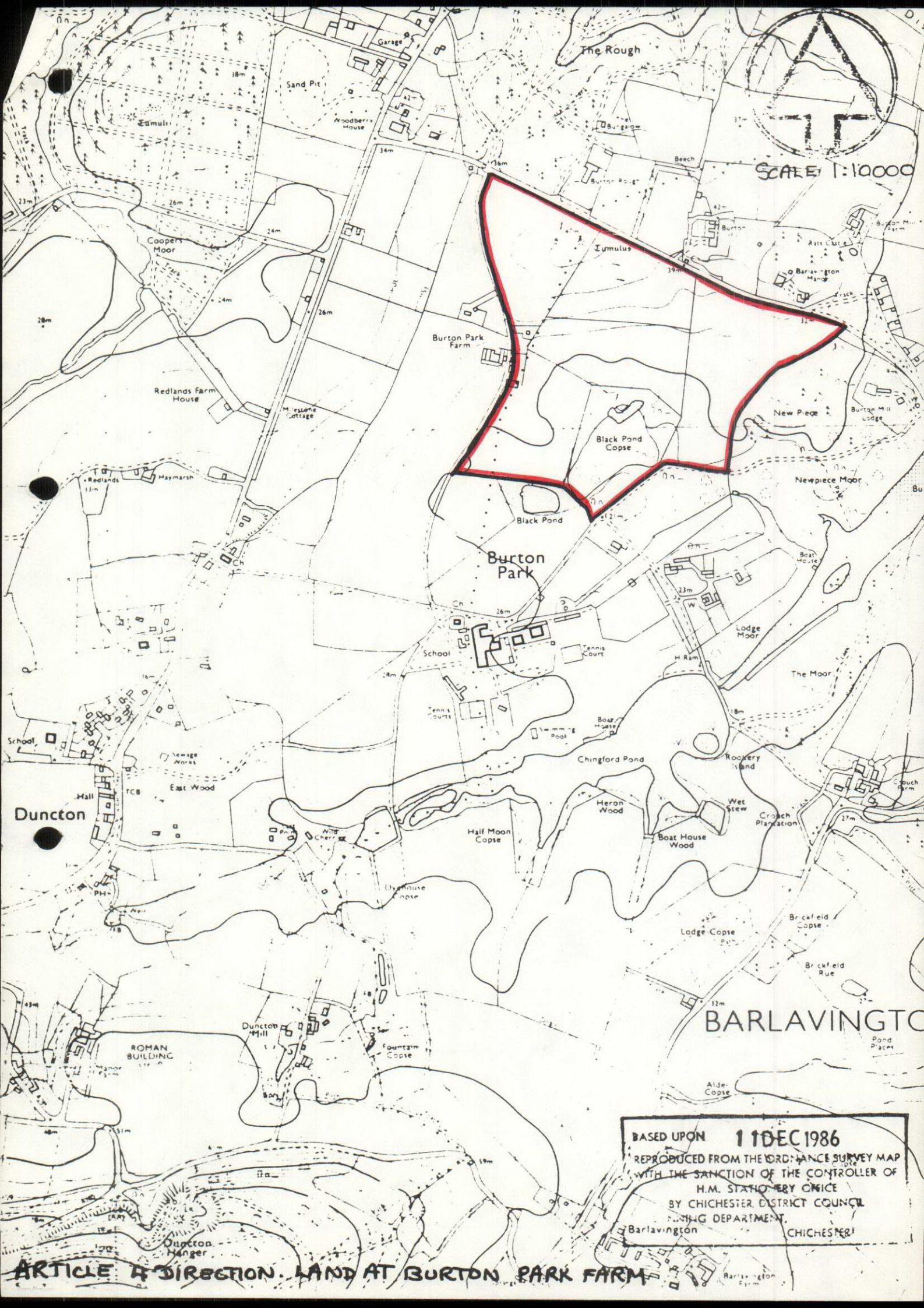

SCALE 1:10000

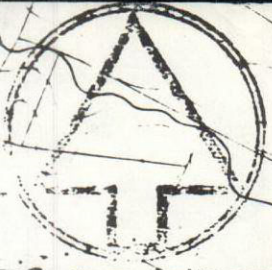

BASED UPON **1 DEC 1986**
 REPRODUCED FROM THE ORDNANCE SURVEY MAP
 WITH THE SANCTION OF THE CONTROLLER OF
 H.M. STATIONERY OFFICE
 BY CHICHESTER DISTRICT COUNCIL
 PLANNING DEPARTMENT.
 BARLAVINGTON CHICHESTER

ARTICLE 4 DIRECTION. LAND AT BURTON PARK FARM

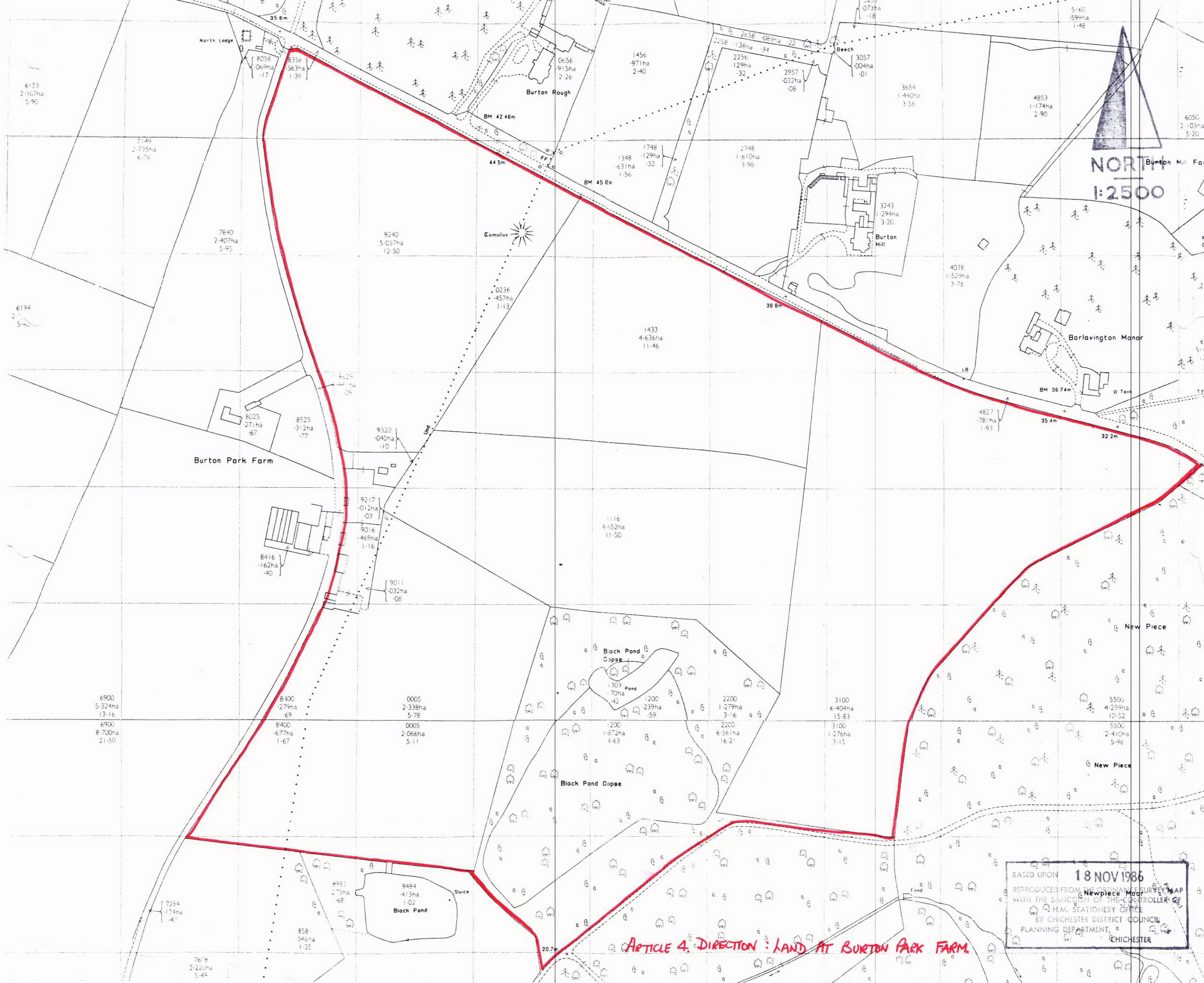

NORTH
1:2500

BASED UPON 18 NOV 1986
 REPRODUCED FROM NEWPIECE HOUSING SURVEY MAP
 WITH THE SANCTION OF THE CONTROLLER OF
 H.M. STATIONERY OFFICE
 BY CHICHESTER DISTRICT COUNCIL
 PLANNING DEPARTMENT,
 CHICHESTER

ARTICLE 4, DIRECTION: LAND AT BURTON PARK FARM.