

Planning Committee Meeting 9 May 2019

Agenda Item 7 - SDNP/I8/06553/FUL

Demolition of existing stables and erection of new single storey dwelling with
associated landscaping

The Beacon Nurseries, Beacon Road, Ditchling, BN6 8XB



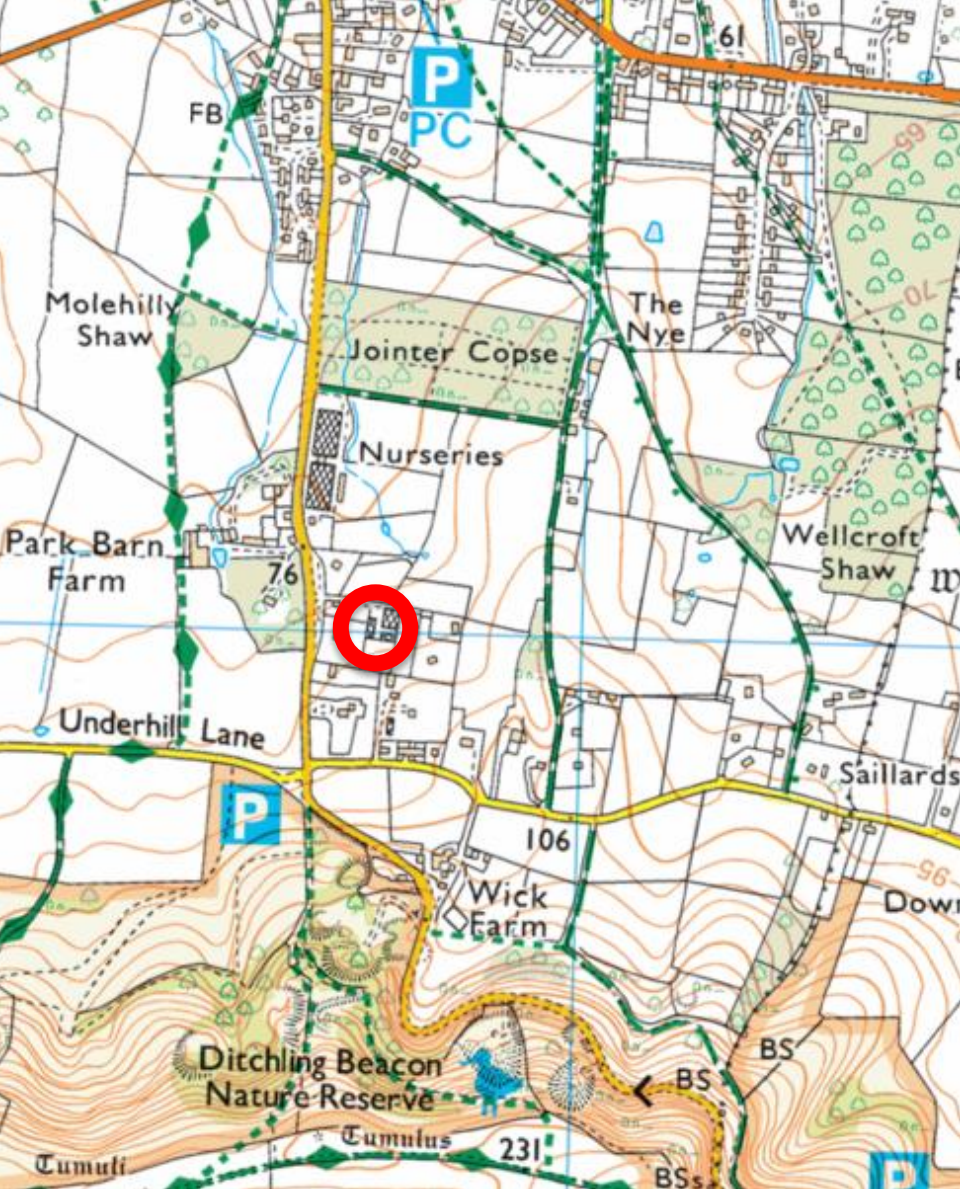





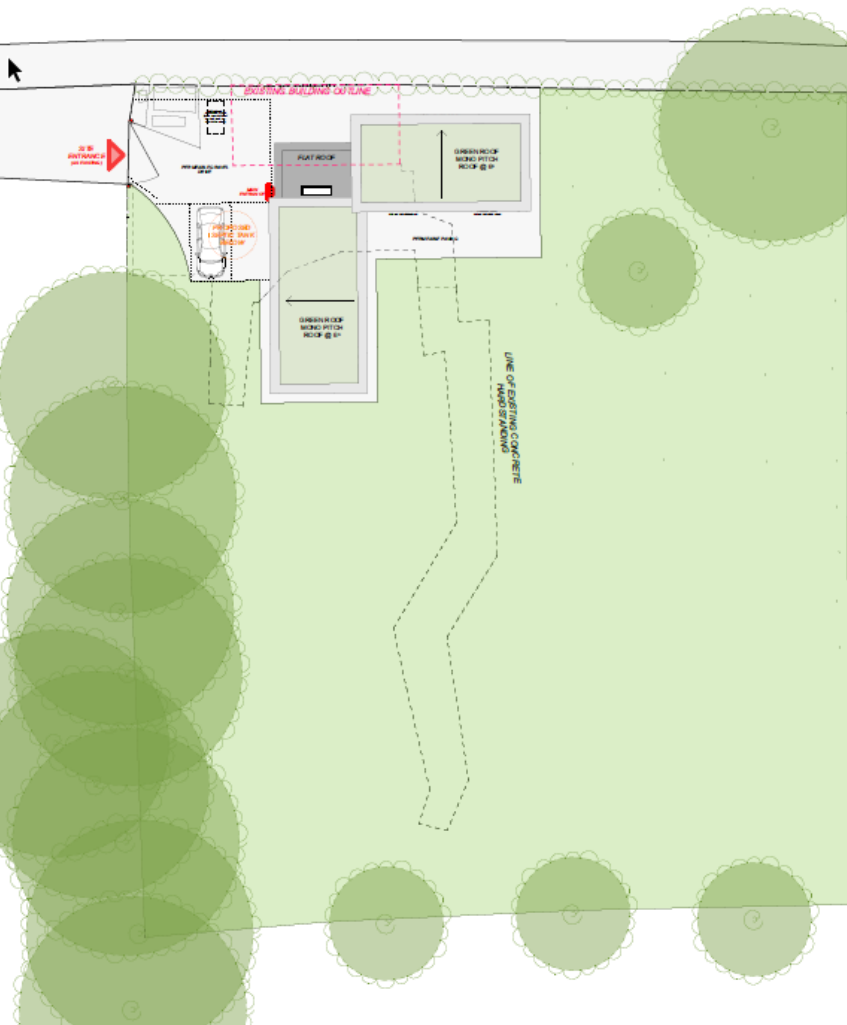

Recommendation for SDNP/I8/06553/FUL

1. The proposed dwelling is located outside of a settlement boundary where policies DS1 of the Ditchling, Streat and Westmeston Neighbourhood Development Plan and SD25 of the submitted SDNPA Local Plan seek to restrict new development. It would not constitute an appropriate re-use of the site and, by reason of its form and intensification of use of the site, would fail to conserve and enhance the special qualities of the National Park. There are no exceptional circumstances to justify a dwelling in this location. The proposal is therefore in conflict with Policies CONS6 and DS1 of the Ditchling, Streat and Westmeston Neighbourhood Development Plan 2017-2032, Policies SD4 and SD25 of the submitted South Downs National Park Local Plan 2014-2033, policy CT1 of the Lewes Local Plan 2003, the NPPF and the first statutory purpose of the National Park.

