

# Planning Committee Meeting

14 June 2018

Old Racecourse, Lewes







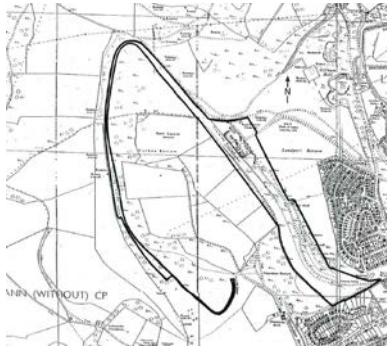

## Article 4 direction (1993)



Lewes Battlefield

## Designations

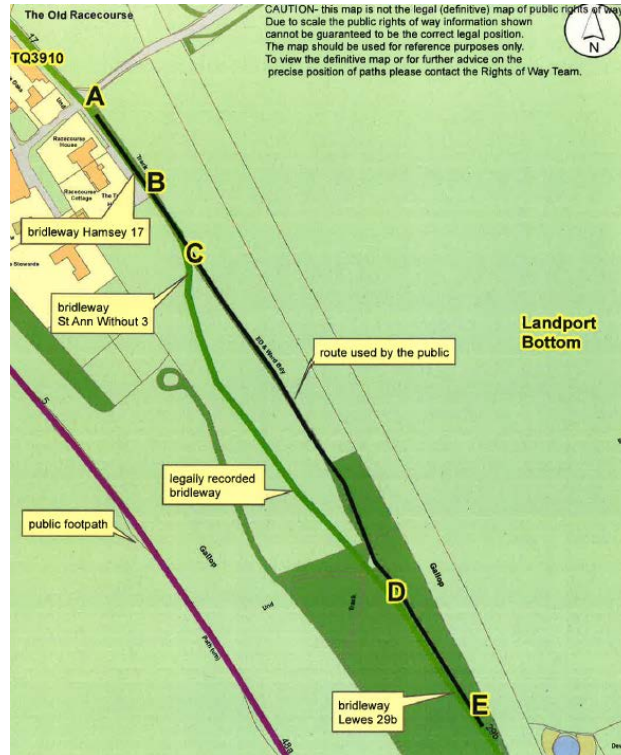

Bridleway Access



Public Access Network



The map shows an aerial view of a residential and commercial area. A red boundary outlines a large section of the map, including a building labeled 'The Old Racecourse' and a 'Public House'. A yellow boundary outlines a smaller section within the red boundary, labeled 'The Old Racecourse'. A blue boundary outlines a large section of the map, including a building labeled 'The Old Racecourse'. A black square highlights a specific area within the blue boundary. Arrows point from the text labels to the corresponding features on the map.

This aerial photograph shows a road intersection. A red line is drawn on the road surface, indicating a lane change or a specific driving path. The surrounding area includes green fields and some buildings.





# Planning Committee Meeting

## 14 June 2018

### Agenda Item 8 – SDNP/18/00138/FUL

Retention of crucifix – a natural finished wooden cross standing within a paddock field adjacent to the Motor Road

The Tote House, The Motor Road, Old Racecourse, Lewes,  
East Sussex, BN7 1UR



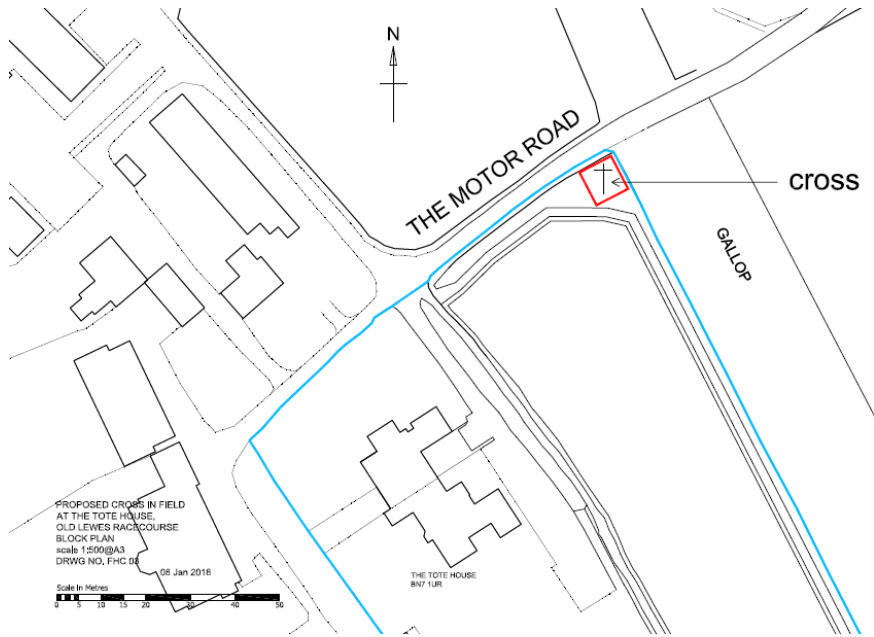

## Recommendation

Approval subject to conditions

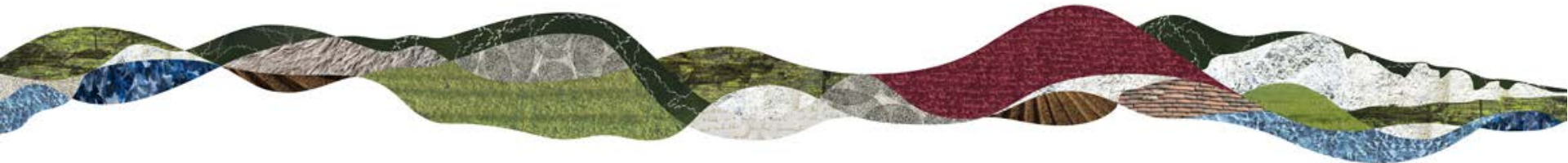

# Planning Committee Meeting

## 14 June 2018

### Agenda Item 9 – SDNP/17/00340/HOUS

Proposed erection of 5 loose box stables

The Tote House, The Motor Road, Old Racecourse, Lewes,  
East Sussex, BN7 1UR



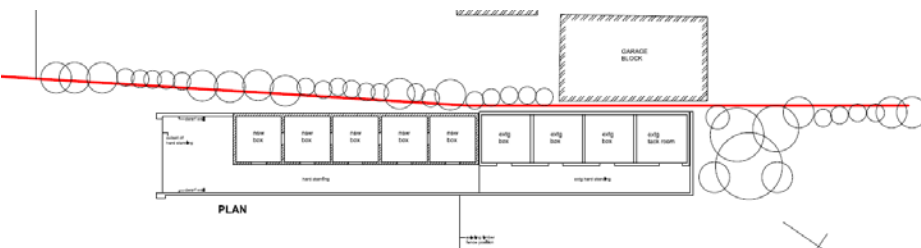
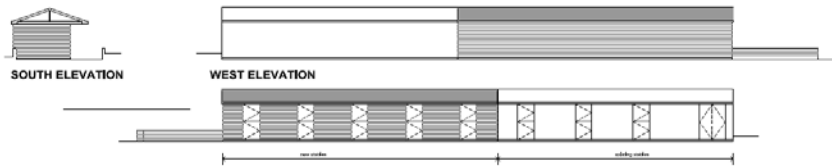

## Recommendation

Approval subject to conditions  
Updated condition No.4

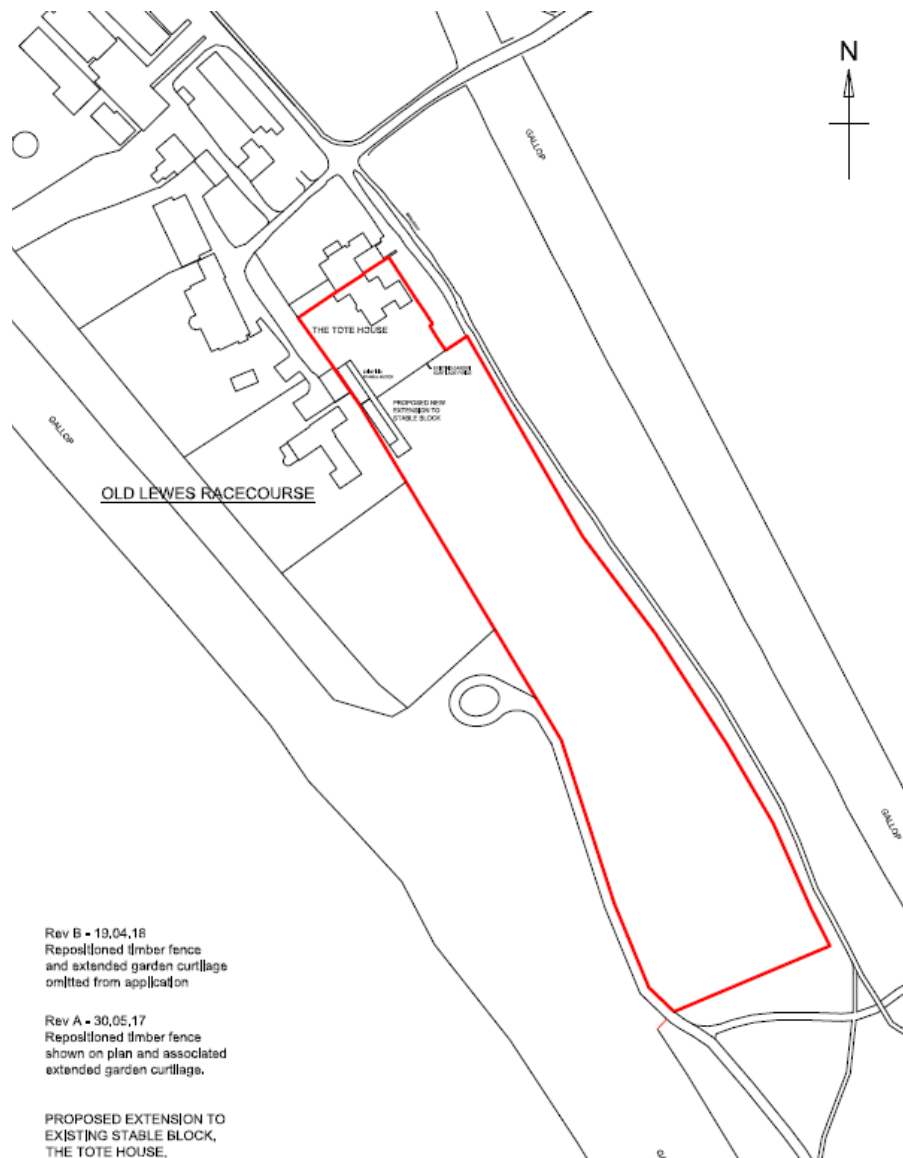



# Planning Committee Meeting

## 14 June 2018

### Agenda Item 10 – SDNP/17/05255/FUL

Renewing existing and installing new fencing work with access gates to reform grazing paddocks for horses into 3 new enclosures at the Old Racecourse Lewes in an area south of the Tote House, including new access tracks for vehicles to the south of the site running parallel to the gallops and a cross route to allow access to the old racetrack gallops land to the west of the site, the new paddock layout accommodates the established existing public bridleway route (Retrospective)

The Tote House, The Motor Road, Old Racecourse, Lewes, East Sussex, BN7 1UR



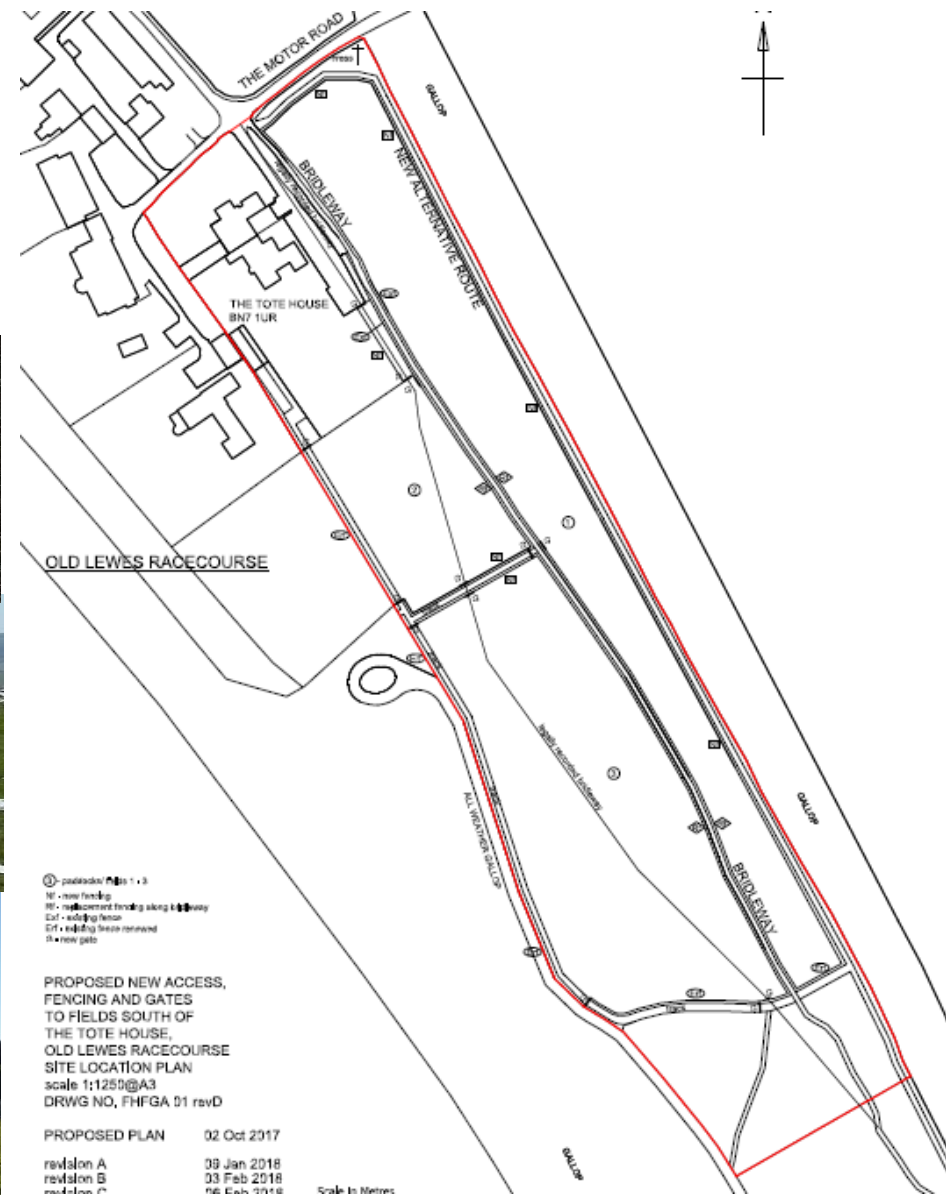
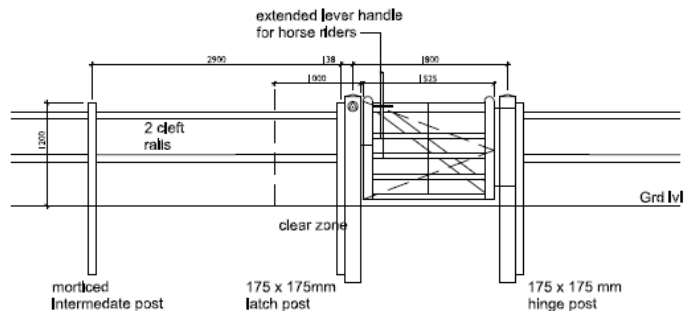



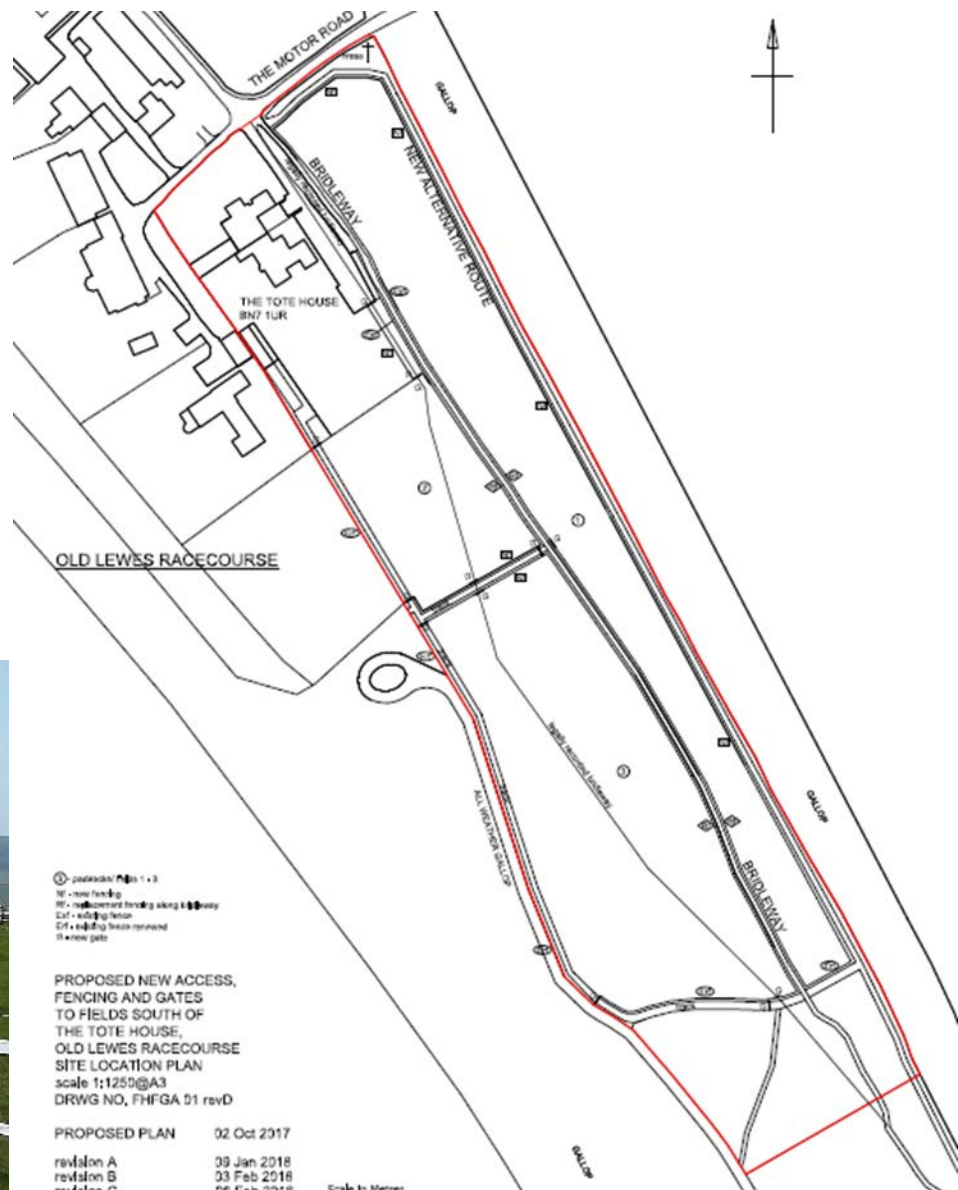
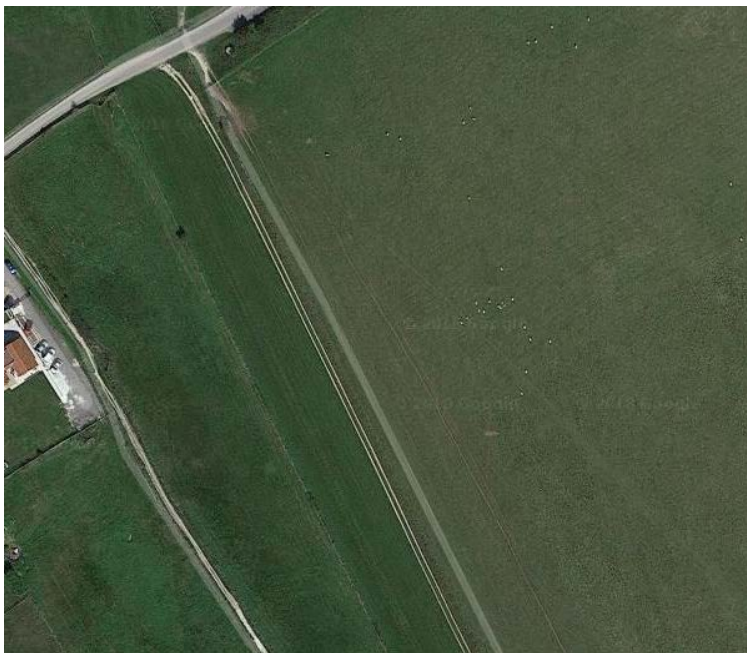

## Recommendation (incorporating update)

1. The fencing, by reason of its sense of enclosure, use of ~~non-locally distinctive materials~~ **prominent materials inappropriate to the landscape context** and lack of justification would fail to conserve or enhance the open downland character of this part of the South Downs National Park or the Lewes Battlefield designation. This would be contrary to policies CT1, ST3, ST11, RE8 and LV9 of the Lewes District Local Plan (2003) and policies CPI0 and CPI the Lewes District Joint Core Strategy (2016), policies SD1, SD4, SD5, SD6, SD12 and SD24 of the emerging South Downs Local Plan: ~~Pre Submission (2017)~~, the NPPF and the first purpose of the National Park.
2. The works to the access track, by reason of the use of ~~non-locally distinctive materials~~ **prominent materials inappropriate to the landscape context** and lack of justification would fail to conserve or enhance the open downland character of this part of the South Downs National Park. This would be contrary to policies CT1, ST3, ST11, RE8 and LV9 of the Lewes District Local Plan (2003) and policies CPI0 and CPI the Lewes District Joint Core Strategy (2016), policies SD1, SD4, SD5, SD6, SD12 and SD24 of the emerging South Downs Local Plan: ~~Pre Submission (2017)~~, the NPPF and the first purpose of the National Park.





# Planning Committee Meeting

14 June 2018

## Agenda Item 11 – SDNP/17/02082/FUL

Retention of temporary electric fencing using chestnut stakes  
to be replaced with chestnut post and rail fencing when  
consent is granted (Retrospective)

The Oaks, The Motor Road, Old Racecourse, Lewes, BN7  
1UR



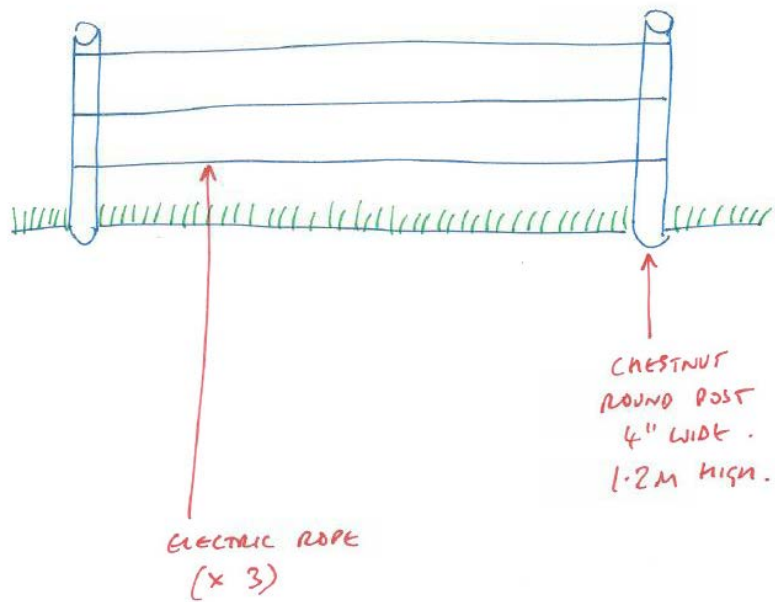

- = ACCESS POINTS
- mmmm = HEDGE LINE
- = TEMPORARY FENCING
- #### = SCRUB



Update

Landscape Officer maintains objection





## Recommendation (incorporating update)

1. The existing post and electric fencing, by reason of its sense of enclosure and use of ~~non-locally distinctive materials~~ **prominent materials inappropriate to the landscape context** is considered to fail to conserve or enhance the open downland character of this part of the South Downs National Park or the Lewes Battlefield designation. This would be contrary to policies CT1, ST3, ST11, RE8 and LV9 of the Lewes District Local Plan (2003) and policies CPI0 and CPI the Lewes District Joint Core Strategy (2016), policies SD1, SD4, SD5, SD6, SD12 and SD24 of the emerging South Downs Local Plan: ~~Pre-Submission (2017)~~, the NPPF and the first purpose of the National Park.

2. The proposed ~~use of chestnut post and rail fence is considered to be uncharacteristic of this landscape setting and it~~ **would introduce prominent materials inappropriate to the landscape context and** would therefore fail to conserve or enhance the open downland character of this part of the South Downs National Park. This would be contrary to policies CT1, ST3, ST11, RE8 and LV9 of the Lewes District Local Plan (2003) and policies CPI0 and CPI the Lewes District Joint Core Strategy (2016), policies SD1, SD4, SD5, SD6, SD12 and SD24 of the emerging South Downs Local Plan: ~~Pre-Submission (2017)~~, the NPPF and the first purpose of the National Park.

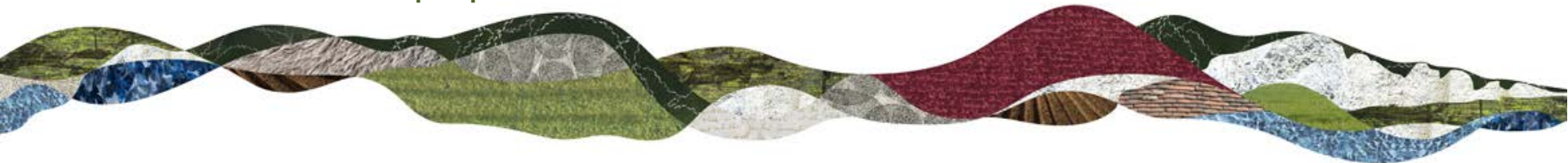

# Planning Committee Meeting

## 14 June 2018

### Agenda Item 12 – SDNP/16/06136/FUL

Construction of manege, fenced surround and shallow earth bank for use as training and exercise facility in connection with stables and livery

The Oaks, The Motor Road, Old Racecourse, Lewes, BN7  
1UR



Post and rail fence surround  
hidden behind bund

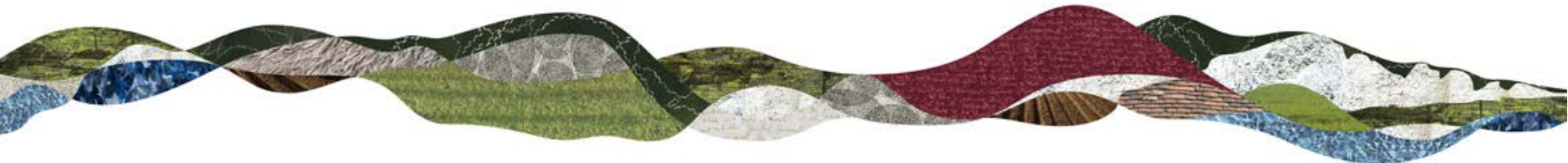
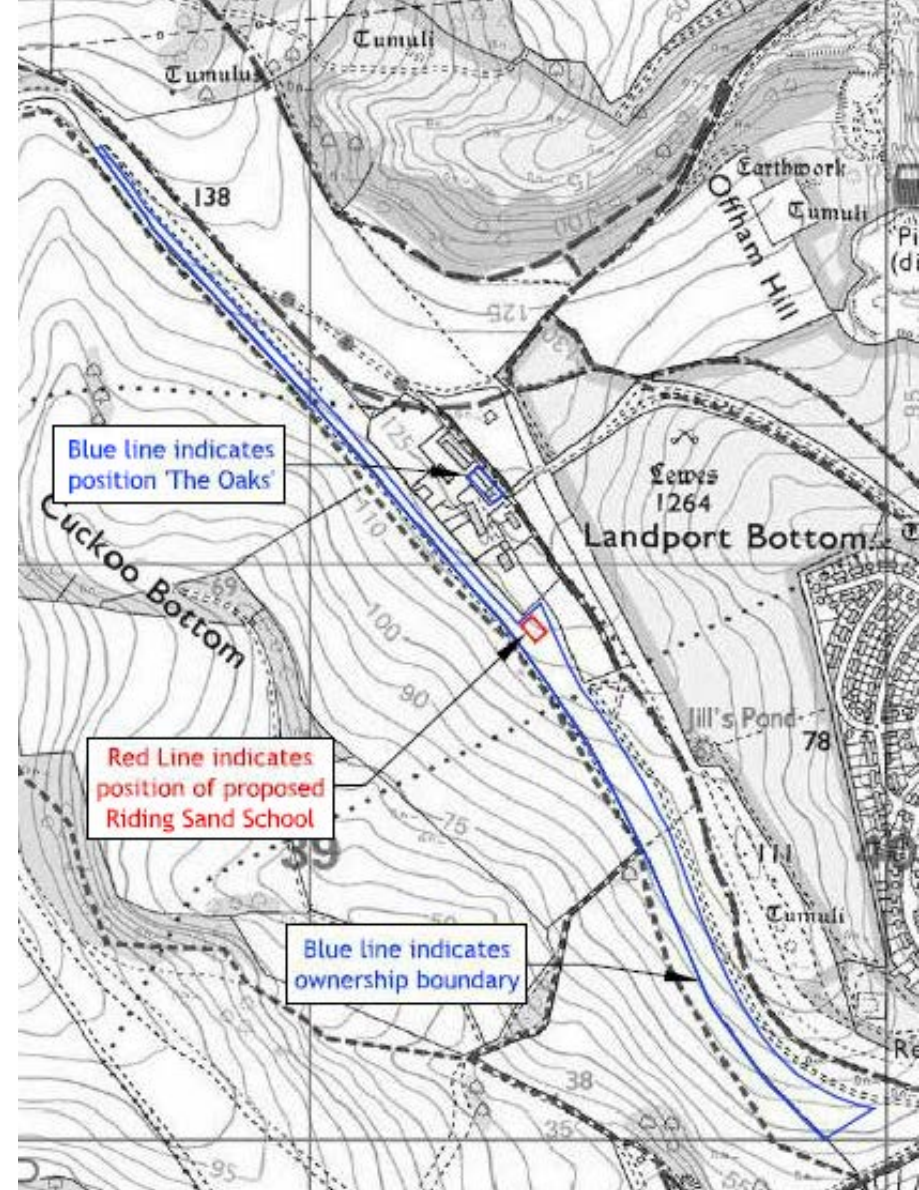
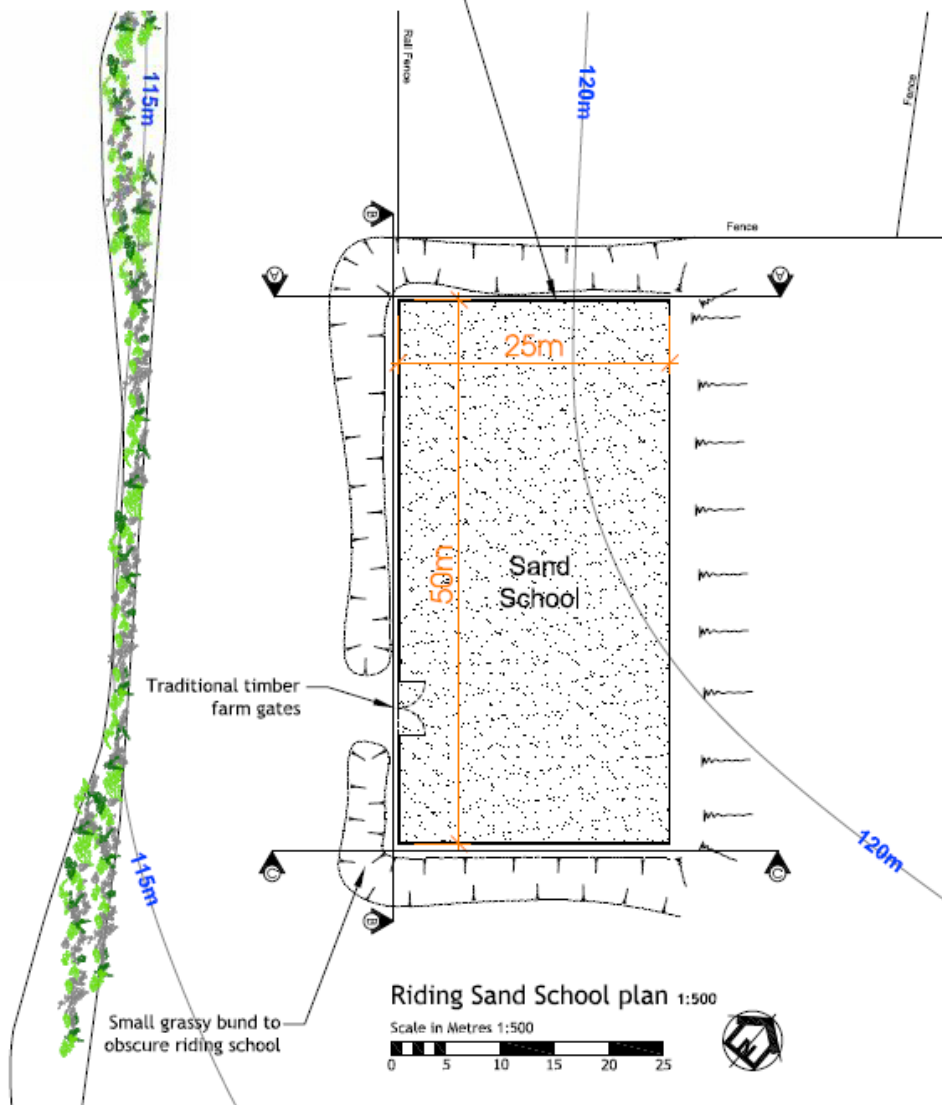



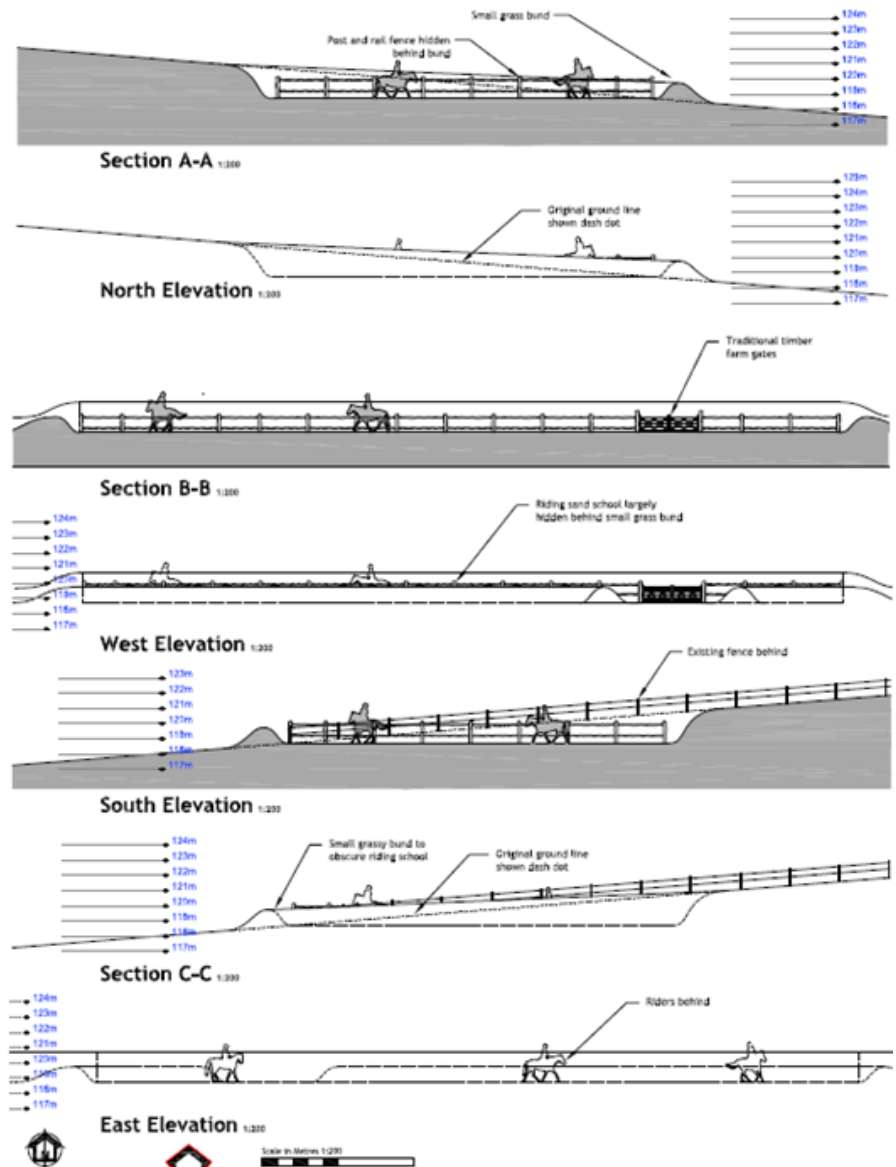
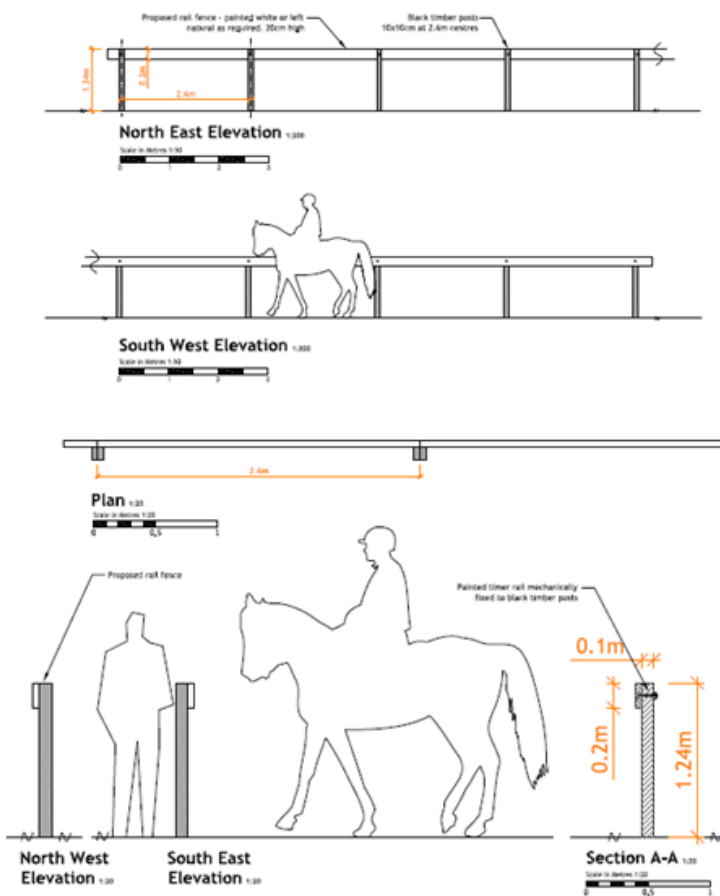

## Recommendation

Approval subject to conditions

