

Centurion Way Extension Phase 2 - Overview

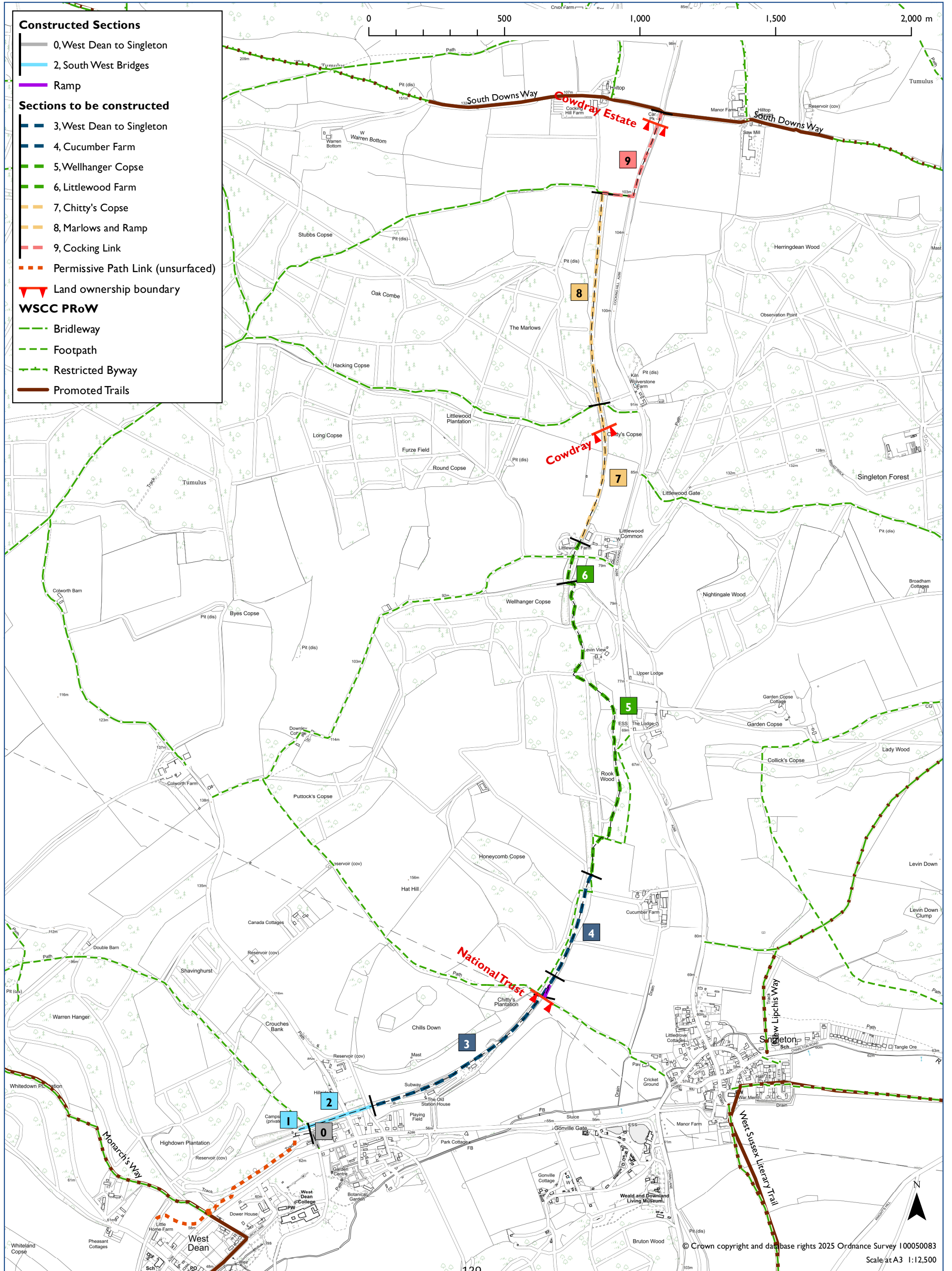

Centurion Way Extension Phase 2 - Pt. I West Dean to Singleton (Sections 1-3)

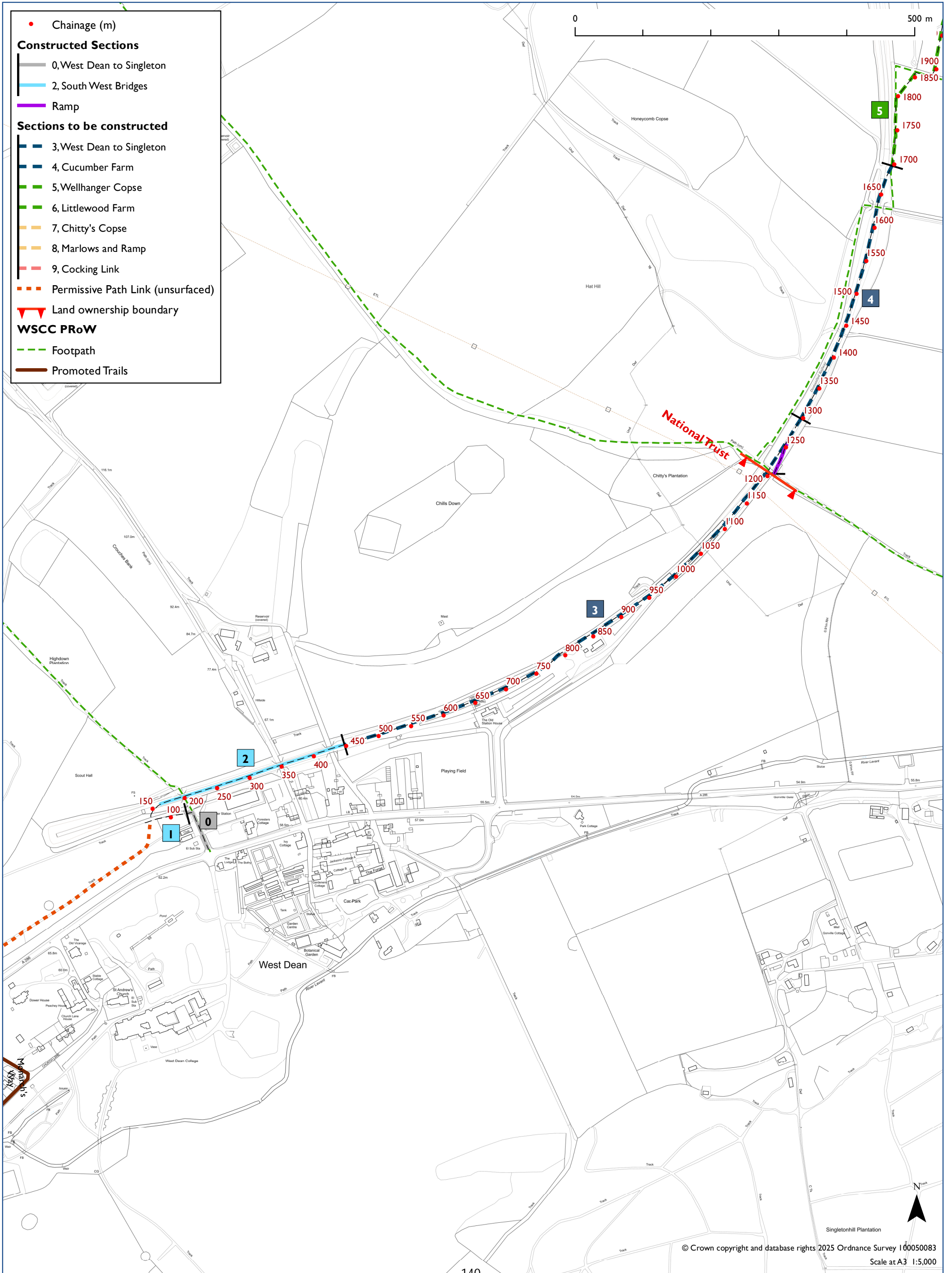

Centurion Way Extension Phase 2 - Pt.2 Singleton to Littlewood Farm (Sections 4-6)

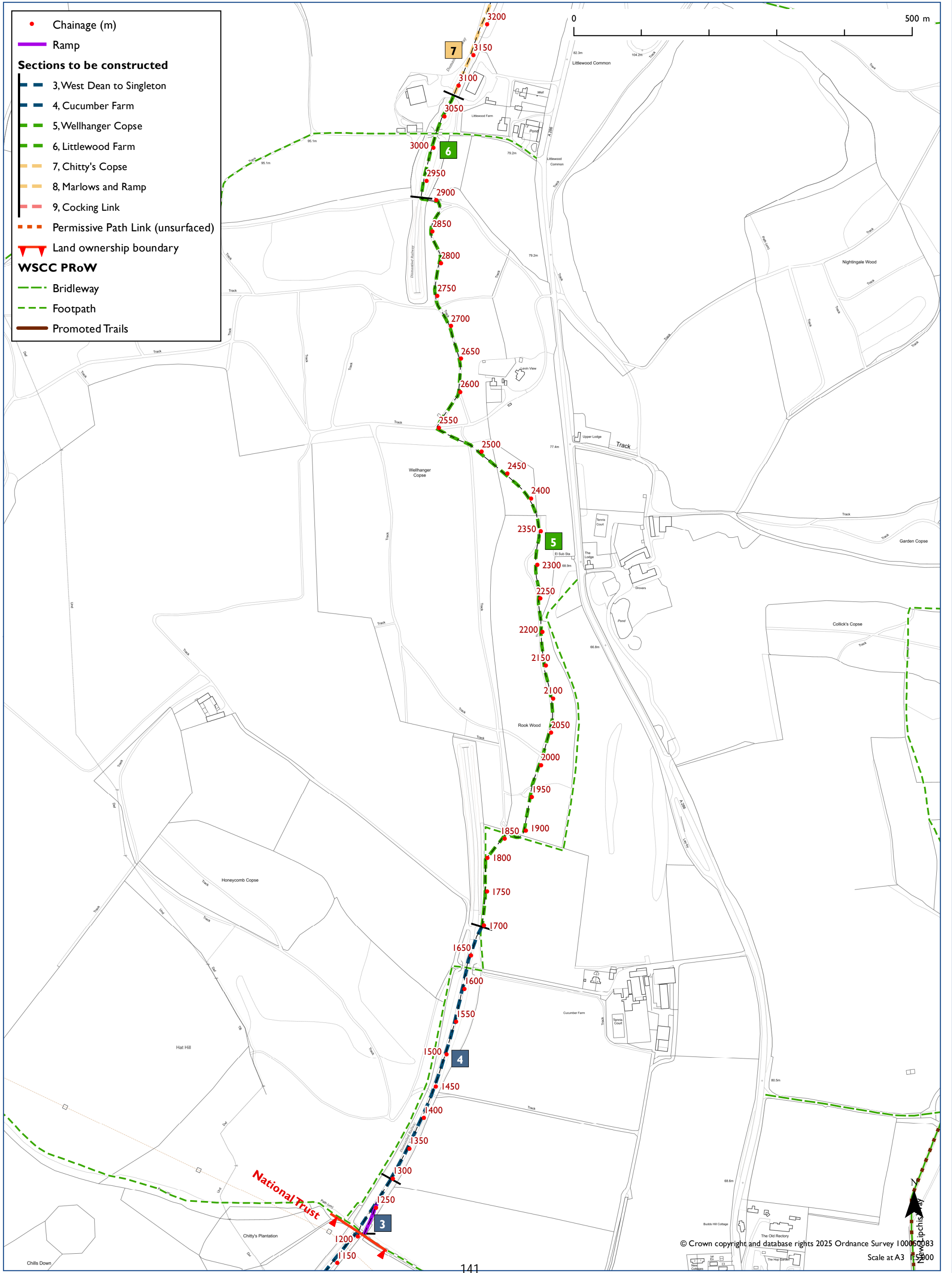

- Chainage (m)
- Ramp
- Sections to be constructed**
- 3, West Dean to Singleton
- 4, Cucumber Farm
- 5, Wellhanger Copse
- 6, Littlewood Farm
- 7, Chitty's Copse
- 8, Marlows and Ramp
- 9, Cocking Link
- - - Permissive Path Link (unsurfaced)
- ▲ Land ownership boundary
- WSCC PRoW**
- - - Bridleway
- - - Footpath
- Promoted Trails

Centurion Way Extension Phase 2 - Pt.3 Littlewood Farm to Cocking (Sections 7-9)

